

SELECT DESIRED OPTION:

9" X 9" BUFFER PAD

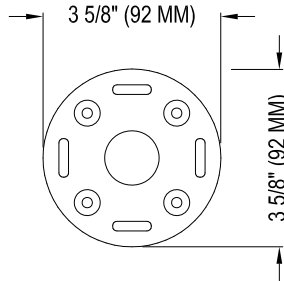

TOP VIEW

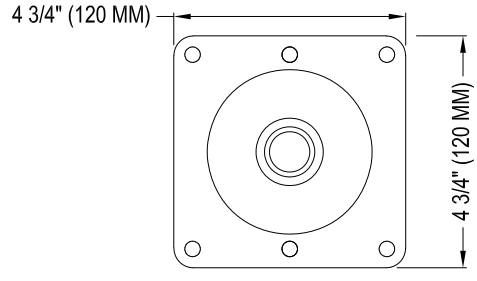

TOP VIEW

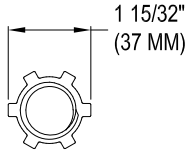

TOP VIEW

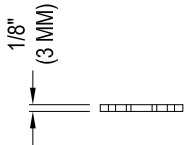

SIDE VIEW  
TIGHTENING NUT

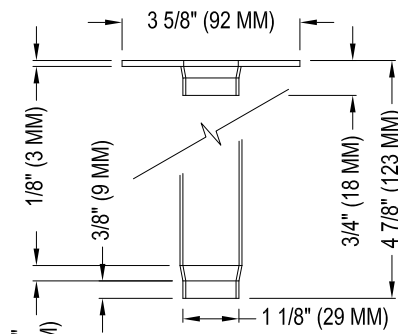

SIDE VIEW  
HEAD

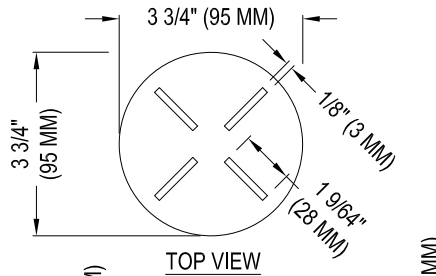

TOP VIEW

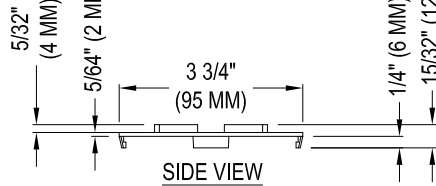

SIDE VIEW  
GASKET

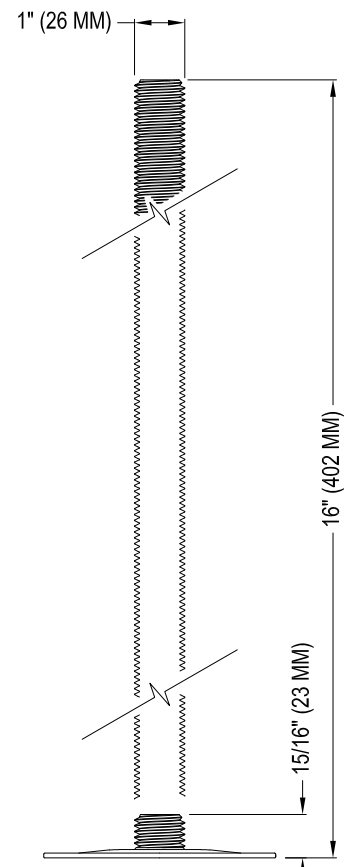

SIDE VIEW  
BASE

**SPECIFICATIONS:**

**MATERIAL:** MILD STEEL

**FINISH:** ZINC-NICKEL ANTI-CORROSION

**BASE SIZE:** 6 1/4" X 6 1/4"

**LOADING:** 2200LB+

**FIRE RATING:** (EN13501-1):A1 - AFL

**GENERAL NOTES:**

1. INSTALLATION TO BE COMPLETED IN ACCORDANCE WITH ARCHATRAK SPECIFICATIONS.
2. DO NOT SCALE DRAWING.
3. THIS DRAWING IS INTENDED FOR USE BY ARCHITECTS, ENGINEERS, CONTRACTORS, CONSULTANTS AND DESIGN PROFESSIONALS FOR PLANNING PURPOSES ONLY AND SHOULD NOT BE USED FOR CONSTRUCTION.
4. ALL INFORMATION CONTAINED HEREIN WAS CURRENT AT THE TIME OF DEVELOPMENT BUT MUST BE REVIEWED AND APPROVED BY ARCHATRAK TO BE CONSIDERED ACCURATE.

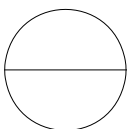

## NON-COMBUSTIBLE PAVER SUPPORTS

ADJUSTABLE HEIGHT STEEL PAVER SUPPORTS